

HH175(36)M 160,165,170,175,180,185,190

Monocrystalline solar modules

Features

- Consisting of premium cells
- Optimized arrangement of the cells guarantees full heat diffusion of the module and thus to decrease the number of hot spots. Using high-quality EVA, TPT and other raw materials to improve the module performance.
- Passing the mechanical load test of IEC 5400Pa, our modules can work in the severest and high-load environment.
- Our modules have low nominal operating cell temperature (NOCT) and remarkable low-light property.

Quality and Safety

- Strict quality monitoring process; 100% current and voltage tests guarantee that the modules meet the power requirement.
- Our modules have passed several international certificates and tests (IEC, TUV, ISO, CE)
- We provide 5-year quality warranty and 25-year power guarantee.

Recommend Applications

- On-grid utility systems
- On-grid commercial systems
- Off-grid PV systems
- Residential roof top systems



Advanced diffusion technology guarantees uniformity of the conversion rate in cell.



Special design on drainage holes and rigid construction prevents frame from defroming or breaking due to freezing weather and other forces.

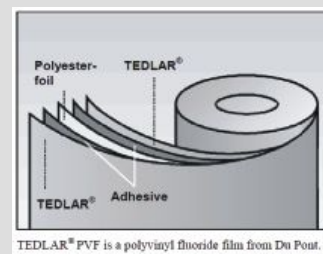

The improved gloss of the Tedlar surface effects a especially reflection to the solar radiation to increase conversion efficiency and resist weather and moisture.

组件外形尺寸
Component Dimensions

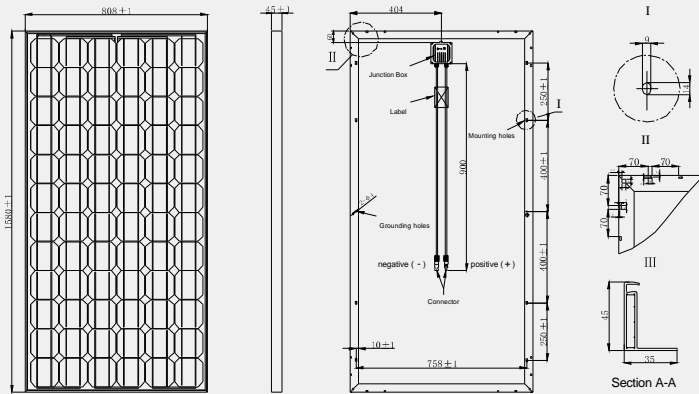

Components Mechanical properties 组件机械特性

电池片 Cell (mm): 125 × 125
尺寸 Dimension (mm): 1580 × 808 × 45
电池数量 No. of Cells: 72 (6 × 12)
重量 Weight (kg): 15.5
玻璃 Glass: 3.2 mm tempered glass
框架 Frame: Anodized aluminium alloy
接线盒 Junction Box: Ip65 rated

Temperature Coefficients 温度系数

标准电池工作温度
Notinal Operating cell Temperature (NOCT) 47 ± 2°C
最大功率温度系数
Temperature Coefficient of Pmax -0.46%/°C
开路电压温度系数
Temperature Coefficient of Voc -0.348%/°C
短路电流温度系数
Temperature Coefficient of Isc +0.031%/°C

Monocrystalline solar modules
单晶硅太阳能电池组件

HH175 (36) M系列 Module Series

Model 型号	Open Circuit Voltage Voc 开路电压 (V)	Short Circuit Current Isc 短路电流 (A)	Optimum Operating Voltage Vmp 工作电压 (V)	Optimum Operating Current Imp 工作电流 (A)	Rated Maximum Power at STC, Pmax最大功率 (W)	Maximum Series Fuse Rating 最大保险丝电流 (A)	Power Tolerance 功率偏差
HH160(36)M	42	5.02	35	4.57	160	10	±3%
HH165(36)M	42.7	5.04	35	4.71	165	10	±3%
HH170(36)M	43.3	5.08	35.5	4.79	170	10	±3%
HH175(36)M	43.3	5.23	35.5	4.93	175	10	±3%
HH180(36)M	43.9	5.3	36	5	180	10	±3%
HH185(36)M	43.9	5.45	36	5.14	185	10	±3%
HH190(36)M	44.5	5.52	36.5	5.21	190	10	±3%

产品特性曲线 Characteristics Curve

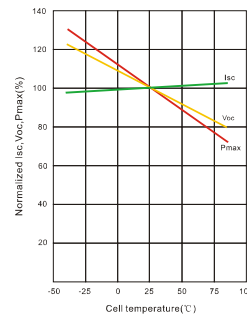
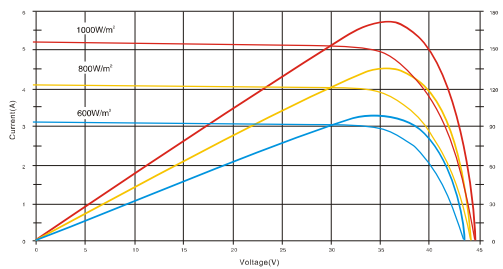

HH225(48)M 205,210,215,220,225,230,235,240,245

Monocrystalline solar modules

Features

- Consisting of premium cells
- Optimized arrangement of the cells guarantees full heat diffusion of the module and thus to decrease the number of hot spots. Using high-quality EVA, TPT and other raw materials to improve the module performance.
- Passing the mechanical load test of IEC 5400Pa, our modules can work in the severest and high-load environment.
- Our modules have low nominal operating cell temperature (NOCT) and remarkable low-light property.

Quality and Safety

- Strict quality monitoring process; 100% current and voltage tests guarantee that the modules meet the power requirement.
- Our modules have passed several international certificates and tests (IEC, TUV, ISO, CE)
- We provide 5-year quality warranty and 25-year power guarantee.

Recommend Applications

- On-grid utility systems
- On-grid commercial systems
- Off-grid PV systems
- Residential roof top systems

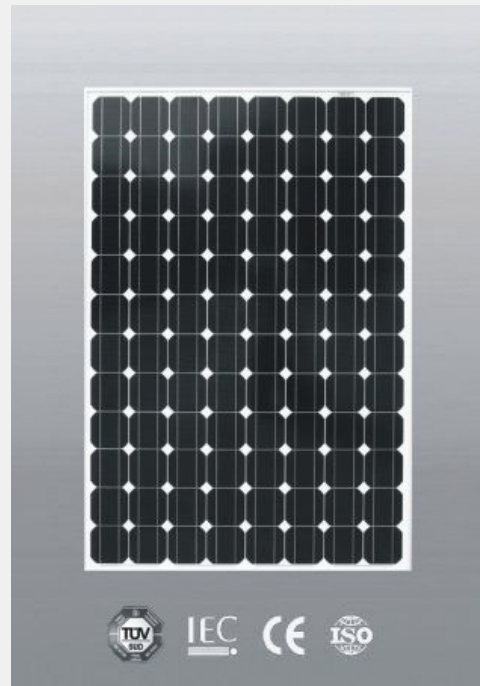

Advanced diffusion technology guarantees uniformity of the conversion rate in cell.



Special design on drainage holes and rigid construction prevents frame from defroming or breaking due to freezing weather and other forces.

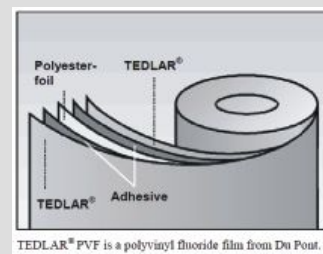

The improved gloss of the Tedlar surface effects a especially reflection to the solar radiation to increase conversion efficiency and resist weather and moisture.

组件外形尺寸
Component Dimensions

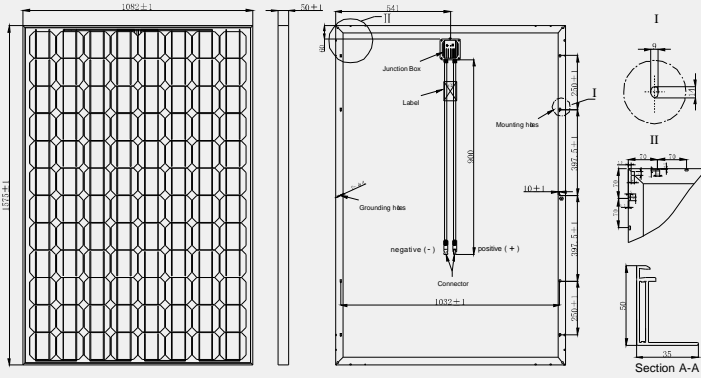

Components Mechanical
properties 组件机械特性

电池片 Cell (mm): 125 × 125
尺寸 Dimension (mm): 1575 × 1082 × 50
电池数量 No. of Cells: 96 (8 × 12)
重量 Weight (kg): 21.5
玻璃 Glass: 3.2 mm tempered glass
框架 Frame: Anodized aluminium alloy
接线盒 Junction Box: Ip65 rated

Temperature Coefficients 温度系数

标准电池工作温度
Notinal Operating cell Temperature (NOCT) 47 ± 2°C
最大功率温度系数
Temperature Coefficient of Pmax -0.46%/°C
开路电压温度系数
Temperature Coefficient of Voc -0.348%/°C
短路电流温度系数
Temperature Coefficient of Isc +0.031%/°C

Monocrystalline solar modules
单晶硅太阳能电池组件

HH225 (48) M系列 Module Series

Model 型号	Open Circuit Voltage Voc 开路电压 (V)	Short Circuit Current Isc 短路电流 (A)	Optimum Operating Voltage Vmp 工作电压 (V)	Optimum Operating Current Imp 工作电流 (A)	Rated Maximum Power at STC, Pmax最大功率 (W)	Maximum Series Fuse Rating 最大保险丝电流 (A)	Power Tolerance 功率偏差
HH205(48)M	56.7	4.72	46.5	4.41	205	10	± 3 %
HH210(48)M	57.3	4.82	47	4.47	210	10	± 3 %
HH215(48)M	57.3	4.94	47	4.57	215	10	± 3 %
HH220(48)M	58	5	47.5	4.63	220	10	± 3 %
HH225(48)M	58	5.07	47.5	4.74	225	10	± 3 %
HH230(48)M	58.6	5.15	48	4.79	230	10	± 3 %
HH235(48)M	58.6	5.23	48	4.89	235	10	± 3 %
HH240(48)M	59.2	5.32	48.5	4.95	240	10	± 3 %
HH245(48)M	59.2	5.40	48.5	5.11	245	10	± 3 %

产品特性曲线 Characteristics Curve

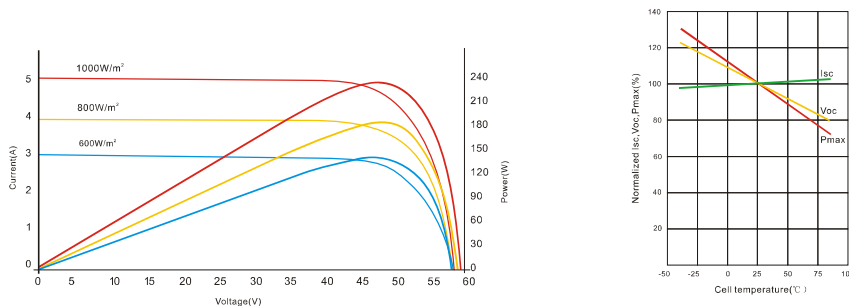

HH220(30)P 200,205,210,215,220,225,230,235,240

Polycrystalline solar modules

Features

- Consisting of premium cells
- Optimized arrangement of the cells guarantees full heat diffusion of the module and thus to decrease the number of hot spots. Using high-quality EVA, TPT and other raw materials to improve the module performance.
- Passing the mechanical load test of IEC 5400Pa, our modules can work in the severest and high-load environment.
- Our modules have low nominal operating cell temperature (NOCT) and remarkable low-light property.

Quality and Safety

- Strict quality monitoring process; 100% current and voltage tests guarantee that the modules meet the power requirement.
- Our modules have passed several international certificates and tests (IEC, TUV, ISO, CE)
- We provide 5-year quality warranty and 25-year power guarantee.

Recommend Applications

- On-grid utility systems
- On-grid commercial systems
- Off-grid PV systems
- Residential roof top systems



Advanced diffusion technology guarantees uniformity of the conversion rate in cell.



Special design on drainage holes and rigid construction prevents frame from deforming or breaking due to freezing weather and other forces.

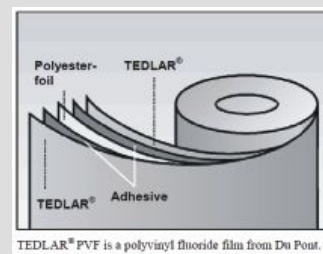

The improved gloss of the Tedlar surface effects a especially reflection to the solar radiation to increase conversion efficiency and resist weather and moisture.

组件外形尺寸
Component Dimensions

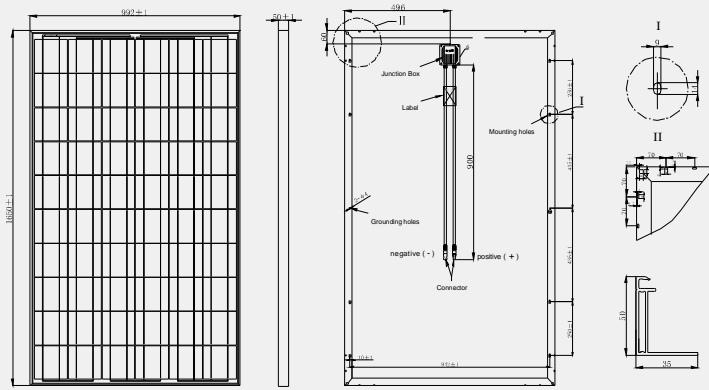

Components Mechanical
properties 组件机械特性

电池片 Cell (mm): 156 × 156
尺寸 Dimension (mm): 1650 × 992 × 50
电池数量 No. of Cells: 60 (6 × 10)
重量 Weight (kg): 19.5
玻璃 Glass: 3.2 mm tempered glass
框架 Frame: Anodized aluminium alloy
接线盒 Junction Box: Ip65 rated

Temperature Coefficients 温度系数

标准电池工作温度
Notinal Operating cell Temperature(NOCT) 47 ± 2°C
最大功率温度系数
Temperature Coefficient of Pmax -0.43%/°C
开路电压温度系数
Temperature Coefficient of Voc -0.33%/°C
短路电流温度系数
Temperature Coefficient of Isc +0.04%/°C

Polycrystalline solar modules
多晶硅太阳能电池组件

HH220 (30) P系列 Module Series

Model	Open Circuit Voltage Voc 开路电压(V)	Short Circuit Current Isc 短路电流(A)	Optimum Operating Voltage Vmp 工作电压 (V)	Optimum Operating Current Imp 工作电流 (A)	Rated Maximum Power at STC, Pmax最大功率(W)	Maximum Series Fuse Rating 最大保险丝电流 (A)	Power Tolerance 功率偏差
HH200(30)P	35.3	7.58	28.5	7.02	200	15	± 3 %
HH205(30)P	35.3	7.77	28.5	7.19	205	15	± 3 %
HH210(30)P	36	7.82	29	7.24	210	15	± 3 %
HH215(30)P	36	8.01	29	7.41	215	15	± 3 %
HH220(30)P	36	8.19	29	7.59	220	15	± 3 %
HH225(30)P	36.6	8.24	29.5	7.63	225	15	± 3 %
HH230(30)P	36.6	8.42	29.5	7.8	230	15	± 3 %
HH235(30)P	37.2	8.46	30	7.83	235	15	± 3 %
HH240(30)P	37.2	8.65	30	8	240	15	± 3 %

产品特性曲线 Characteristics Curve

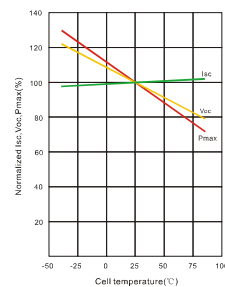
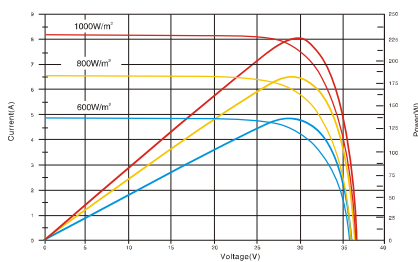

HH265(36)P 240,245,250,255,260,265,270,275,280,285,290

Polycrystalline solar modules

Features

- Consisting of premium cells
- Optimized arrangement of the cells guarantees full heat diffusion of the module and thus to decrease the number of hot spots. Using high-quality EVA, TPT and other raw materials to improve the module performance.
- Passing the mechanical load test of IEC 5400Pa, our modules can work in the severest and high-load environment.
- Our modules have low nominal operating cell temperature (NOCT) and remarkable low-light property.

Quality and Safety

- Strict quality monitoring process; 100% current and voltage tests guarantee that the modules meet the power requirement.
- Our modules have passed several international certificates and tests (IEC, TUV, ISO, CE)
- We provide 5-year quality warranty and 25-year power guarantee.

Recommend Applications

- On-grid utility systems
- On-grid commercial systems
- Off-grid PV systems
- Residential roof top systems



Advanced diffusion technology guarantees uniformity of the conversion rate in cell.



Special design on drainage holes and rigid construction prevents frame from defroming or breaking due to freezing weather and other forces.

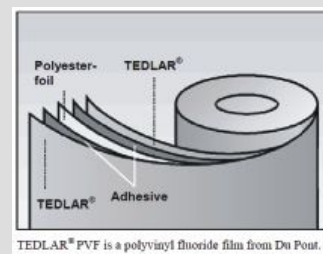

The improved gloss of the Tedlar surface effects a especially reflection to the solar radiation to increase conversion efficiency and resist weather and moisture.

组件外形尺寸
Component Dimensions

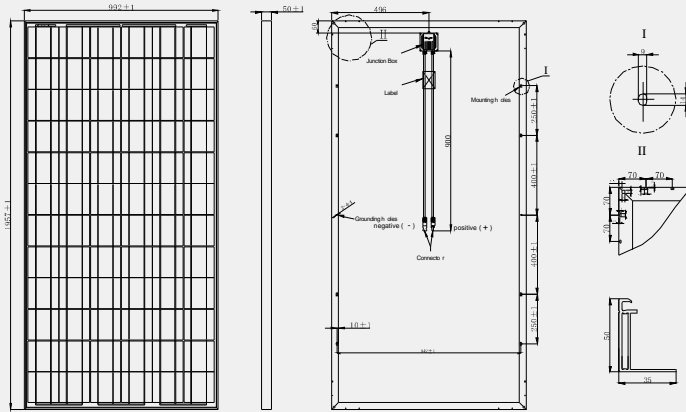

Components Mechanical properties 组件机械特性

电池片 Cell (mm): 156 × 156
尺寸 Dimension (mm): 1957 × 992 × 50
电池数量 No. of Cells: 72 (6 × 12)
重量 Weight (kg): 22.5
玻璃 Glass: 3.2 mm tempered glass
框架 Frame: Anodized aluminium alloy
接线盒 Junction Box: Ip65 rated

Temperature Coefficients 温度系数

标准电池工作温度
Notinal Operating cell Temperature(NOCT) 47 ± 2°C
最大功率温度系数
Temperature Coefficient of Pmax -0.43%/°C
开路电压温度系数
Temperature Coefficient of Voc -0.33%/°C
短路电流温度系数
Temperature Coefficient of Isc +0.04%/°C

Polycrystalline solar modules
多晶硅太阳能电池组件

HH265 (36) P系列 Module Series

Model 型号	Open Circuit Voltage Voc 开路电压(V)	Short Circuit Current Isc 短路电流(A)	Optimum Operating Voltage Vmp 工作电压 (V)	Optimum Operating Current Imp 工作电流 (A)	Rated Maximum Power at STC, Pmax最大功率(W)	Maximum Series Fuse Rating 最大保险丝电流 (A)	Power Tolerance 功率偏差
HH240(36)P	42.8	7.51	34.5	6.96	240	15	±3%
HH245(36)P	42.8	7.66	34.5	7.1	245	15	±3%
HH250(36)P	43.4	7.71	35	7.14	250	15	±3%
HH255(36)P	43.4	7.87	35	7.29	255	15	±3%
HH260(36)P	43.4	7.95	35	7.43	260	15	±3%
HH265(36)P	44	8.06	35.5	7.46	265	15	±3%
HH270(36)P	44	8.14	35.5	7.61	270	15	±3%
HH275(36)P	44	8.3	35.5	7.75	275	15	±3%
HH280(36)P	44.6	8.41	36	7.78	280	15	±3%
HH285(36)P	44.6	8.57	36	7.91	285	15	±3%
HH290(36)P	44.6	8.69	36.5	7.95	290	15	±3%

产品特性曲线 Characteristics Curve

